

ZLA-.5, female luer adapter to 1/32" fitting

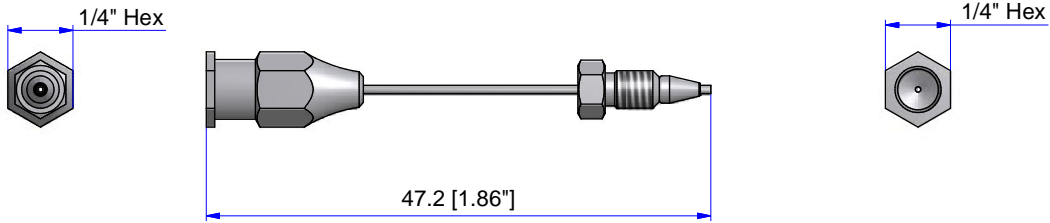

ZLA-1, female luer adapter to 1/16" fitting

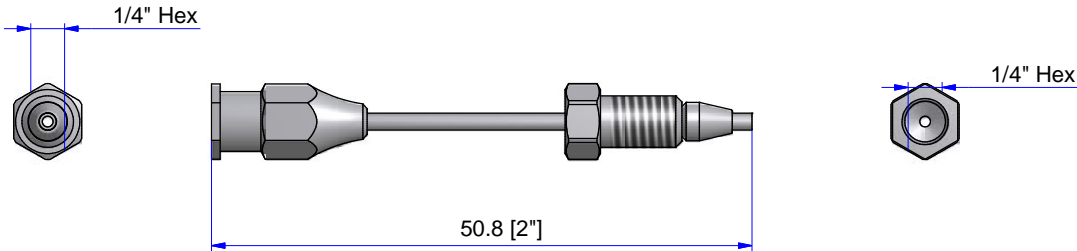

ZLA-2, female luer adapter to 1/8" fitting

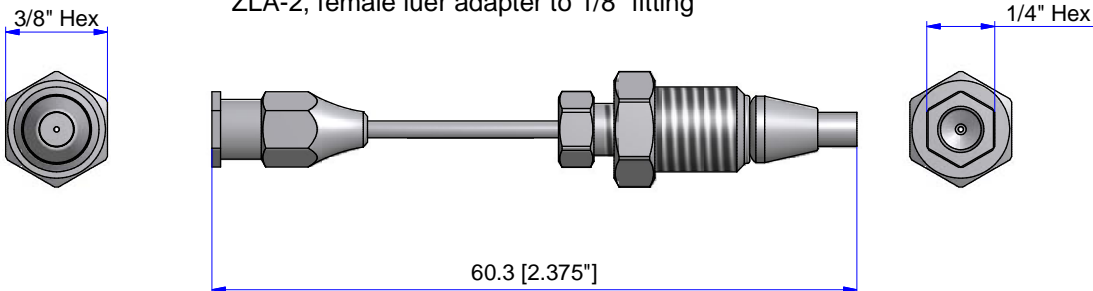

VISF-1, syringe fill port

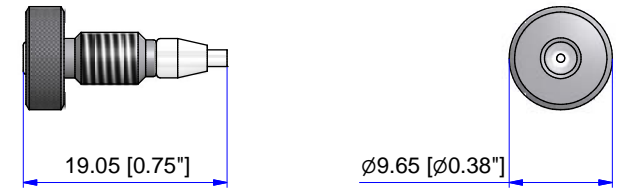

VISF-2, syringe fill port

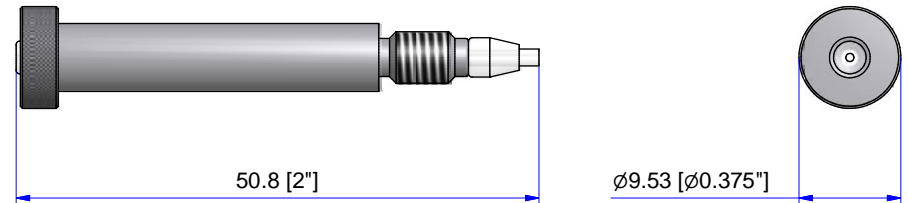

Dimension in mm [Inch]

THIS DOCUMENT AND THE INFORMATION WHICH IT CONTAINS SHALL NOT BE USED, EXPLOITED OR SOLD, AND SHALL NOT BE REVEALED OR DISCLOSED TO OTHERS WITHOUT THE EXPRESS WRITTEN PERMISSION OF VICI. THIS DOCUMENT SHALL REMAIN THE PROPERTY OF VICI AND SHALL BE RETURNED UPON DEMAND.

Aenderungen: a) 10.06.10 FP #621, added female luer adapters  
MODIFICATIONS:

PART NO.:

Material MATERIAL	Dimensionen DIMENSIONS
Allgemein Toleranzen GENERAL TOLERANCES	
SN EN 22768-1/ISO 2768	

## Syringe adapters

General dimensions

**VICI**<sup>®</sup> VICI AG International, CH-6214 Schenkon

Masstab SCALE	Gezeichnet DRAWN	07.02.2006	F.P.
2:1	Gepflicht / Freigabe CHECKED/RELEASE	10.06.2010	FCo
	CAD Nr. CAD NO.	506070.idw	

Unterverz.:  
SUB DIREC.: KUNDE

Zeichnungs Nr. / DRAWING NO.

**3 - GE - 5060.70 a**